

MASON COUNTY

Development Areas Map 1



COUNTY COMMISSIONERS

| | | |
|---------------------|--------------------|------|
| Lynda Ring Erickson | District 1 | Date |
| Tim Sheldon | District 2 | Date |
| Jayni Kamin | District 3 | Date |
| Rebecca Rogers | Clerk of the Board | Date |

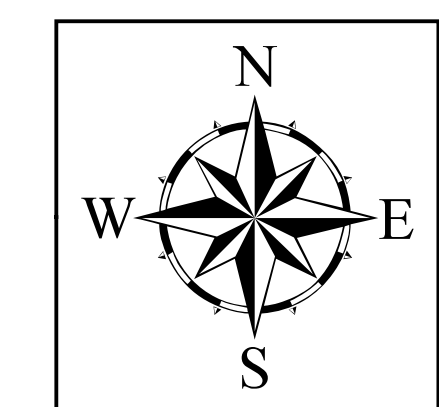

Detail D1

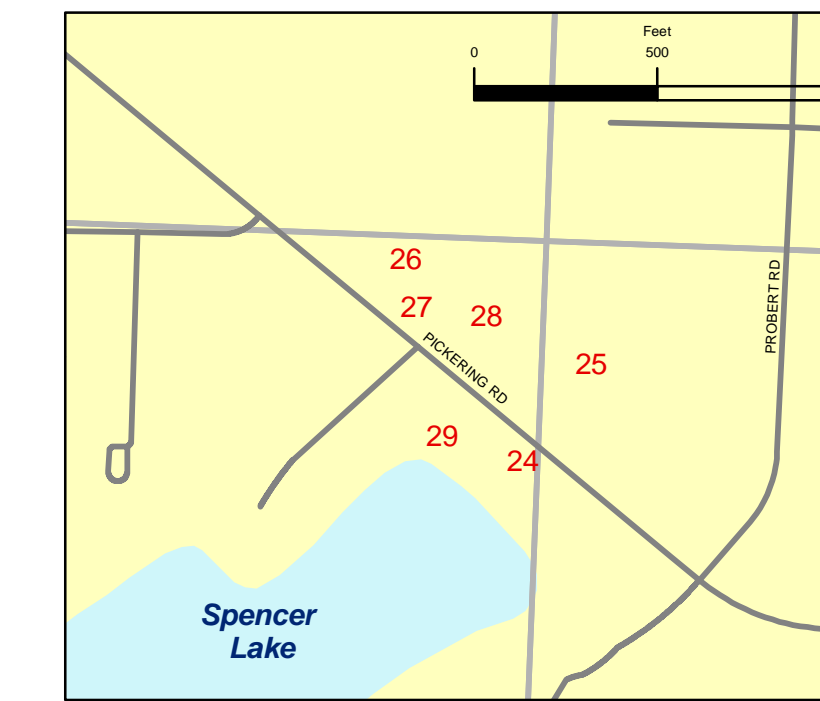

Detail D2

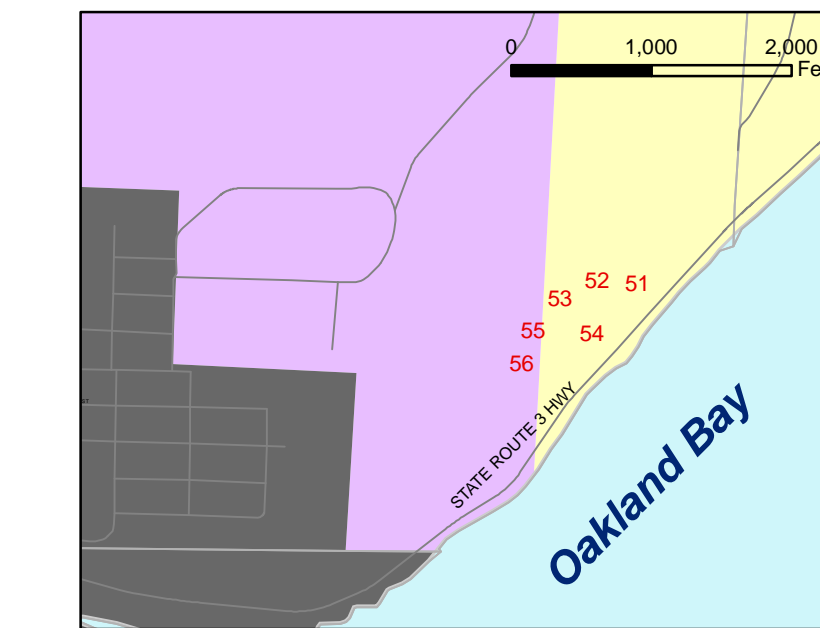

Detail D3

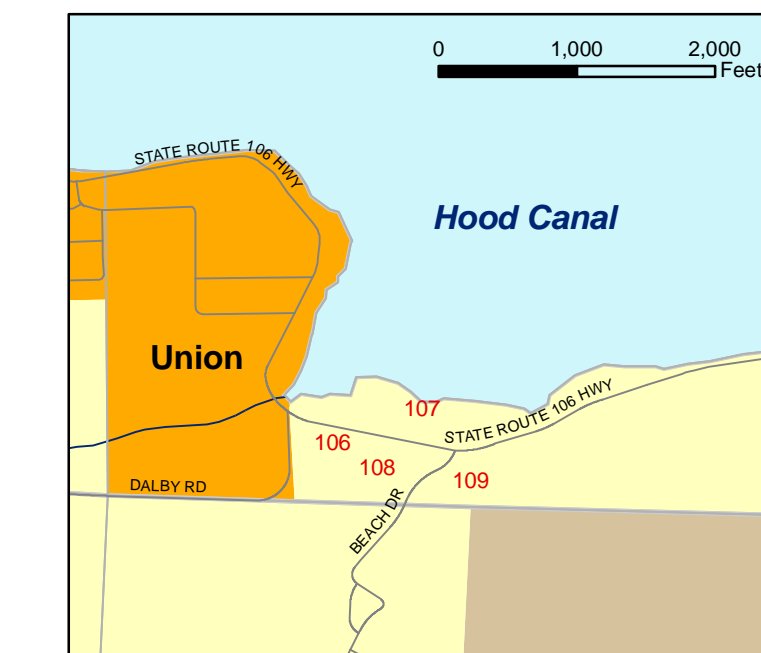

Detail D4

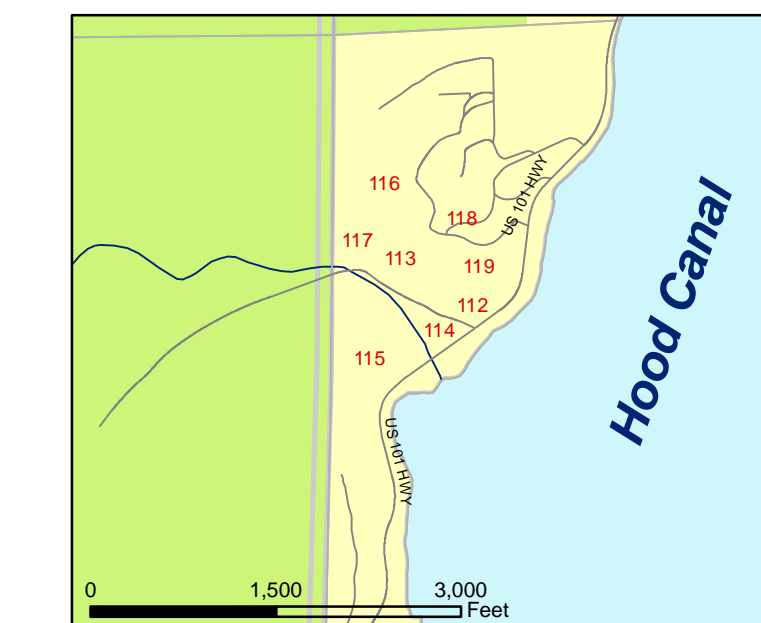

Detail D5

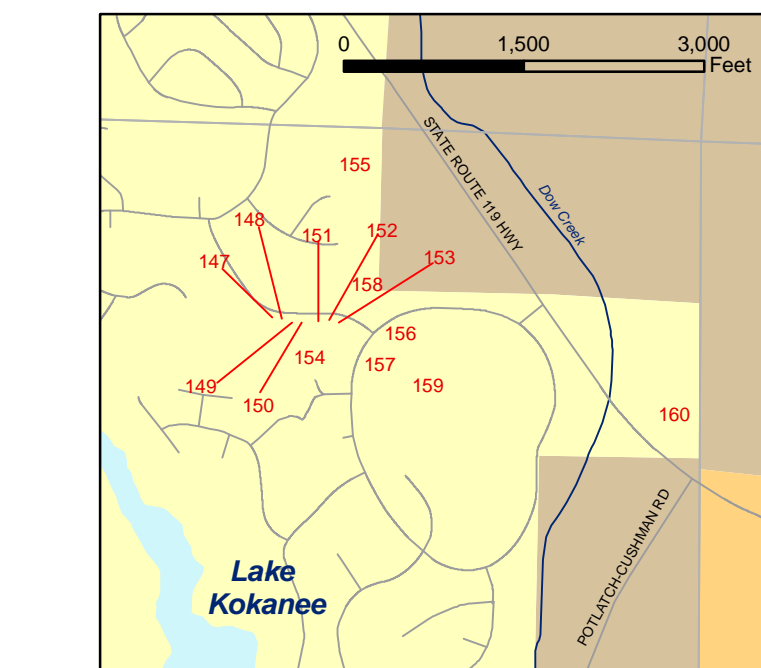

Detail D6

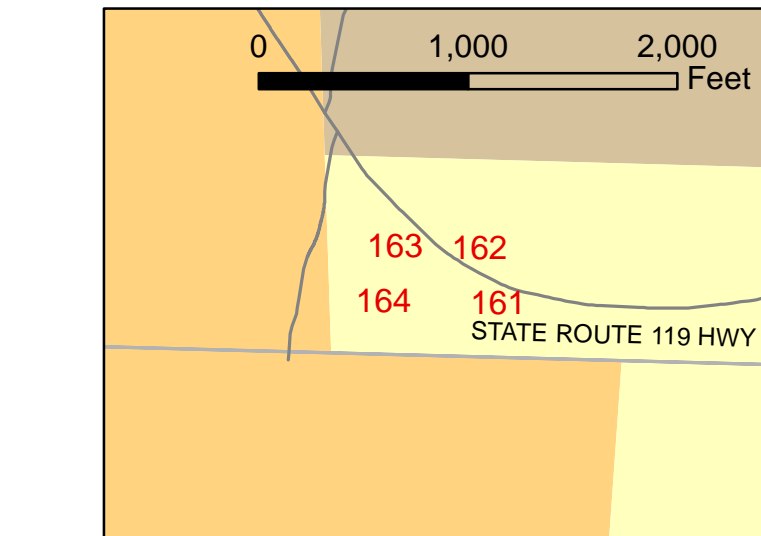

Detail D7

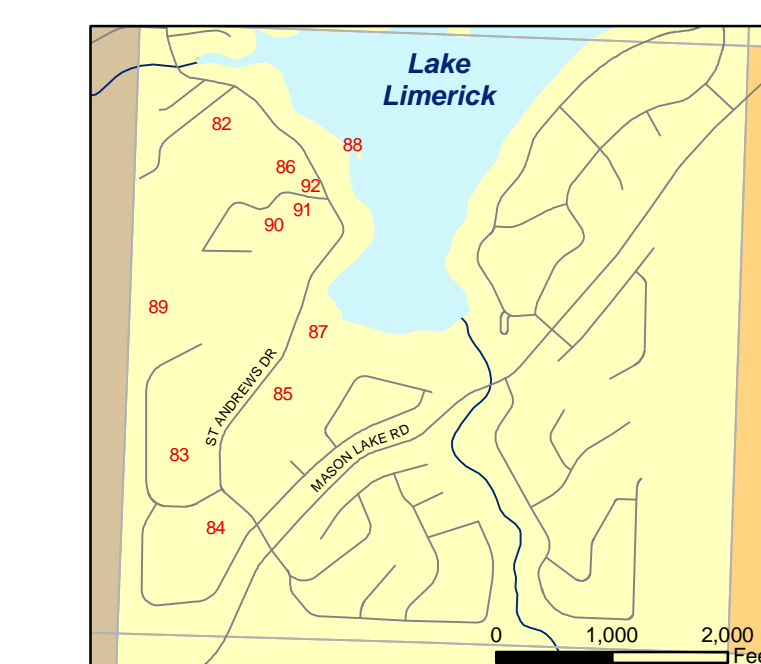

Legend

| | | |
|-----------------------------|--------------------------------------|-----------------------------|
| Resource Lands | Zoning Code | Rural Lands |
| Rural Natural Resource | | Rural Residential 2.5 Acres |
| Agricultural Land | | In Holding Land |
| Long Term Commercial Forest | | Rural Residential 5 Acres |
| Olympic National Park | | Rural Residential 10 Acres |
| Olympic National Forest | | Rural Residential 20 Acres |
| | | Rural Activity Center |
| Other Lands | | Rural Tourist Center |
| Urban Growth Area | | Rural Industrial/Commercial |
| CITY | | |
| Indian Reservation | | |
| | Other Features | |
| | Isolated Commercial Industrial Areas | Water Bodies |
| | Hamlets | Rivers |
| | ICIA Map Number | Roads |



Produced by: Mason County Department of Community Development
 Project File: Users_Projects/Planning_Dept/Zoning/Zoning.mxd
 Publication Date: 12/05/2005

This map was made using ArcGIS 9.1

Data Sources
 Zoning was created in October of 2005 by the Planning Department by reviewing the previous Development Areas Map 1, using parcel and plat line layers to best estimate the location of zoning boundaries, and by using section maps from the Department of Community Development
Hydrology Layer (Water Bodies and Water Courses) is from the Washington State Department of Natural Resources 1996.
Townships and Sections are from Public Works GIS Department.
Isolated Commercial/Industrial Areas are from the Mason County Development Areas Map 1 03/2003.
ICIA Numbers are from the Mason County Development Areas Map 1 03/2003, and through a parcel search based on parcel information from the Mason County Development Regulations Table A on Page 67, and by using Orthophotos from the Public Works GIS Department to best visually locate the buildings related to these points.
Streets are from the Public Works GIS Department
Hamlets are from the Mason County Development Areas Map 1 03/2003

DISCLAIMER AND LIMITATION OF LIABILITY
 The data used to make this map have been tested for accuracy, and every effort has been made to ensure that these data are timely, accurate and reliable. However, Mason County makes no guarantee or warranty to its accuracy as to labeling, dimensions, or placement or location of any map features contained herein. The boundaries depicted by these data are approximate, and are not necessarily accurate to surveying or engineering standards. These data are intended for informational purposes and should not be considered authoritative for engineering, navigational, legal and other site-specific uses. Mason County does not assume any legal liability or responsibility arising from the use of this map in a manner not intended by Mason County. In no event shall Mason County be liable for direct, indirect, incidental, consequential, special, or tort damages of any kind, including, but not limited to, loss of anticipated profits or benefits arising from use of or reliance on the information contained herein. The burden for determining fitness for use lies entirely with the user and the user is solely responsible for understanding the accuracy limitation of the information contained in this map.

