



MASON COUNTY
DEPARTMENT OF COMMUNITY DEVELOPMENT
BUILDING • PLANNING • FIRE MARSHAL

Mason County Bldg. 8,
615 W. Alder Street
Shelton, WA 98584

(360) 427-9670 Shelton ext.352
(360) 275-4467 Belfair ext. 352
(360) 482-5269 Elma ext. 352

www.co.mason.wa.us

ALTERNATE BRACED WALL PANEL
(ABP 1800# AND 3000#) IRC R602.10.3.2

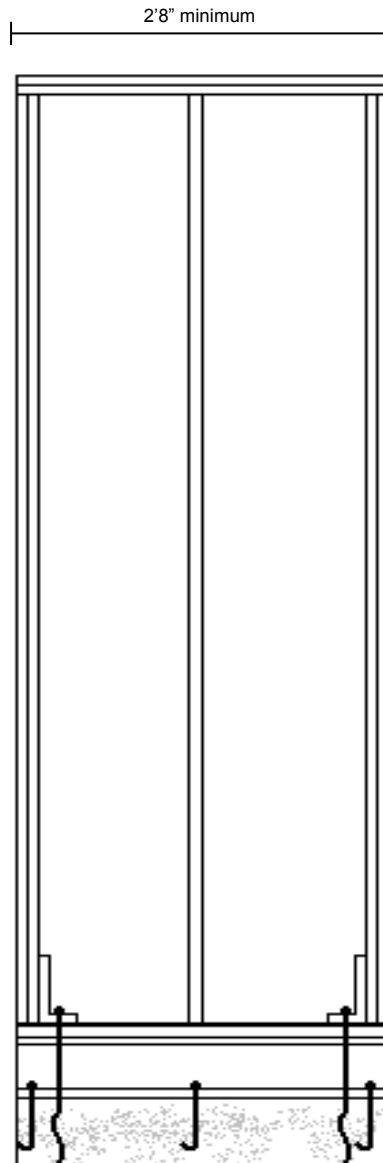

1800# ABP

Minimum 2'8" panel width
Maximum 10'0" height
3/8" APA rated sheathing one
side
Secure with 8d nails
Edge: 6" o.c.
Field: 12" o.c.

1800# uplift capacity tie down
devices at each end, installed
in accordance with the
manufacturer specifications.

2 anchor bolts at panel
quarter points

#4 reinforcement bar at the
top and bottom

Panels shall be supported
directly on a foundation
which is continuous across
the entire length of the
braced wall line.

3000# ABP

Minimum 2'8" panel width
Maximum 10'0" height
3/8" APA rated sheathing
both sides.
Secure with 8d nails
Edge: 4" o.c.
Field: 12" o.c.

3000# uplift capacity tie down
devices at each end,
installed in accordance with
the manufacturer
specifications.

3 anchor bolts at one-fifth
points

#4 reinforcement bar at the
top and bottom

Panels shall be supported
directly on a foundation
which is continuous across
the entire length of the
braced wall line.

**USE 1800# UPLIFT CAPACITY TIE DOWNS ON SINGLE STORY OR SECOND
STORY OF A TWO STORY STRUCTURE.**

**USE 3000# UPLIFT CAPACITY TIE DOWNS ON THE FIRST STORY OF A TWO
STORY STRUCTURE.**